

3D Paper Snowflake Tutorial

3D Paper Snowflake Supplies:

6 sheets of paper (normal copy paper will work fine), cut into identical size squares

Stapler

Clear Tape

Scissors/Paper Trimmer

STEP 1: CUT THE PAPER

Cut 6 sheets of regular printer/copy paper into 8 1/2" squares.

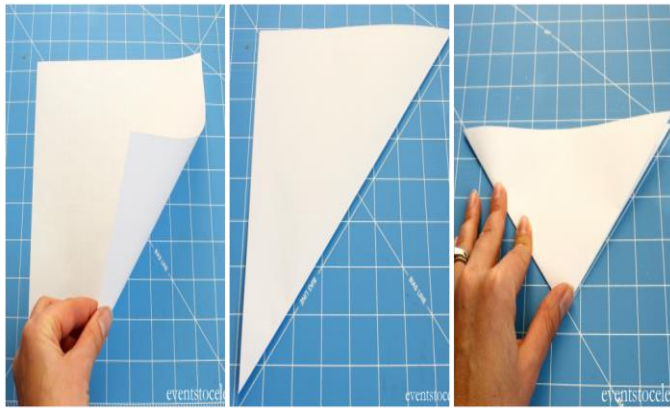

STEP 2: FOLD EACH PIECE

Fold each square diagonally from bottom right corner to top left corner to create a triangle. Fold corners again to make a smaller triangle. Repeat with each of the 5 remaining pieces.

STEP 3: CUT EACH PIECE

Use scissors to cut from the side with the double folds toward the single fold of the triangle. Be sure to end your cut about 1/4" from the edge. Repeat with each of the 5 remaining pieces.

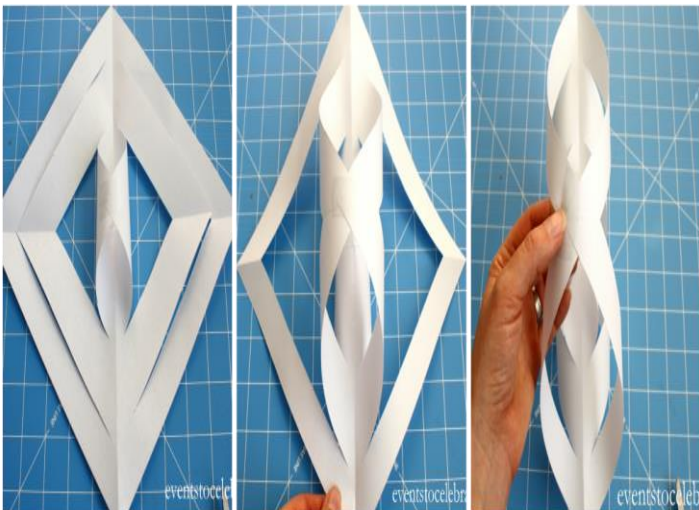
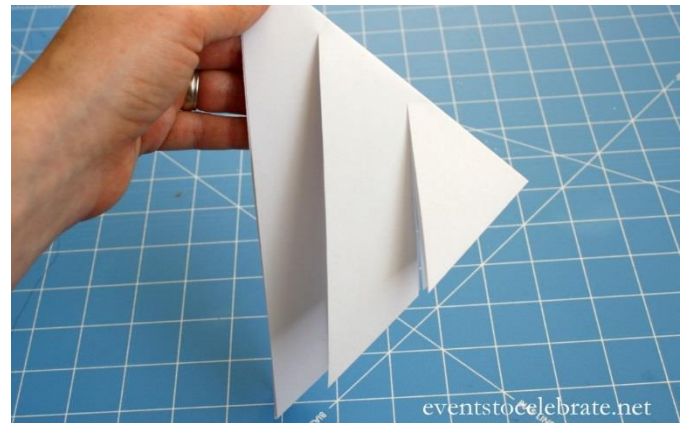

STEP 4: UNFOLD & TAPE ALTERNATING DIRECTIONS

Unfold the triangle and rotate so the uncut center line is vertical. Take the innermost cuts and bring them to the center – making a roll. Secure with a small piece of tape. Turn the paper over and roll the next paper cuts to the center in the opposite direction from the first ones and secure with a piece of tape. Last, turn the paper over again and take the remaining pieces and bring them to the center and secure with a small piece of tape. Repeat with each of the 5 remaining pieces.

STEP 5: ARRANGE & STAPLE

Lay your six pieces out into a snowflake pattern. Pinch three of the centers together and secure with a staple. Pinch the remaining three centers together and secure with a staple. Then take the two halves and staple them together. Last, add a staple to the connection point in between each section.

